

Einzelheit Z M 1:5

Einzelheit X M 1:5

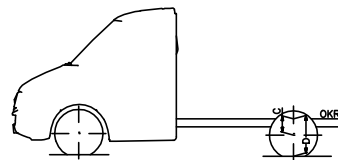
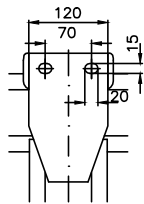
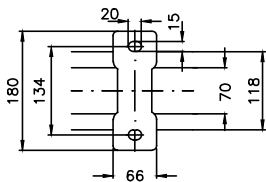

Material thickness: Body support 0.1.0 mm  
Longitudinal member 0.1.0 mm

**IF3** Chassis with cab  
**IK3** Sprinter standard  
**IM** Wheelbase 4325 mm, overhang 1815 mm  
**MO3** Engine OM 681 DE 22 LA 120 kW (163 hp) 3800 rpm  
**MH3** Engine transmission EPA 14/GWB  
**RI7** Tyre LT 215/85 R16  
**SD4** Adjustable co-driver's seat  
1040 Frontal

**Important notes:**  
- It is the responsibility of the bodybuilder to ensure that the vehicle is suitable for homologation after the body has been mounted.  
- The drawing is simplified to some extent and is not legally binding. For more details and further explanations please see the MBAC-Truck User Guide in the bodybuilder portal.  
- Please check whether the drawing specification complies with the chassis configuration of your order.  
- Optional equipment codes not listed here, KW-codes and changes resulting from feasibility checks (BBA) are not included in the drawing.

vehicle type:	A	B	C	D	G	$\alpha^\circ$	$\beta^\circ$	$\delta^\circ$	All dimensions refer to the standard version. Measurements of laden vehicle.	
	laden*	laden*	unladen	laden*	laden*	unladen	unladen			
906.155-13	-	-	-	25.5	25.5	26.9	= 95.1	18	13	14
tyres	215/85R16									
	215/85R16									
gross vehicle weight			GW (t)	FA (t)	RA (t)	Subject to change.				
			2269	839						
*laden = Stalke work to capacity										

Our instructions for the manufacture of superstructures must be observed, when planning in fit bodies of other than Mercedes-Benz manufacturers.

Dimensions are subject to a tolerance of up to +/- 3%.

Adapt. (Dept.) TE/800  
70546 Stuttgart

**Mercedes-Benz** Cab chassis  
3500/4x2/170.3  
HVA 9061000127